



FIRE CODE / LAND USE / BUILDING REVIEW APPLICATION

North Operating Center
 11945 SW 70th Avenue
 Tigard, OR 97223
 Phone: 503-649-8577

South Operating Center
 8445 SW Elligsen Rd
 Wilsonville, OR 97070
 Phone: 503-649-8577

REV 6-30-20

Project Information

Applicant Name: Brian O'Rourke
 Address: 9600 SW Nimbus Ave, Suite 100
 Phone: 503-946-9365 x209
 Email: brian.orourke@3i-consulting.com
 Site Address: 7800 SW Sagert St & 20400 SW Martinazzi Ave
 City: Tualatin
 Map & Tax Lot #: 2S125BA00100
 Business Name: Alden Apartments
 Land Use/Building Jurisdiction: City of Tualatin
 Land Use/ Building Permit # Pre-App 22-0004

Choose from: Beaverton, Tigard, Newberg, **Tualatin**, North Plains, West Linn, Wilsonville, Sherwood, Rivergrove, Durham, King City, Washington County, Clackamas County, Multnomah County, Yamhill County

Project Description

Removal of two existing apartment buildings and associated site features. Addition of 12 buildings (45 total townhome style apartment units) including associated roads, pedestrian paths, and site utilities.

Permit/Review Type (check one):

- Land Use / Building Review - Service Provider Permit
- Emergency Radio Responder Coverage Install/Test
- LPG Tank (Greater than 2,000 gallons)
- Flammable or Combustible Liquid Tank Installation (Greater than 1,000 gallons)
 - * Exception: Underground Storage Tanks (UST) are deferred to DEQ for regulation.
- Explosives Blasting (Blasting plan is required)
- Exterior Toxic, Pyrophoric or Corrosive Gas Installation (in excess of 810 cu.ft.)
- Tents or Temporary Membrane Structures (in excess of 10,000 square feet)
- Temporary Haunted House or similar
- OLCC Cannabis Extraction License Review
- Ceremonial Fire or Bonfire (For gathering, ceremony or other assembly)

For Fire Marshal's Office Use Only

TVFR Permit # 2022-0097
 Permit Type: SPP
 Submittal Date: 8/30/22
 Assigned To: ORourke
 Due Date: _____
 Fees Due: _____
 Fees Paid: _____

Approval/Inspection Conditions
 (For Fire Marshal's Office Use Only)

This section is for application approval only

[Signature] ORourke 8/30/22
 Fire Marshal or Designee Date

Conditions:

X PLEASE SUBMIT FIRE FLOW RESULTS ASAP.

See Attached Conditions: Yes No

Site Inspection Required: Yes No

This section used when site inspection is required

Inspection Comments:

Final TVFR Approval Signature & Emp ID _____ Date _____

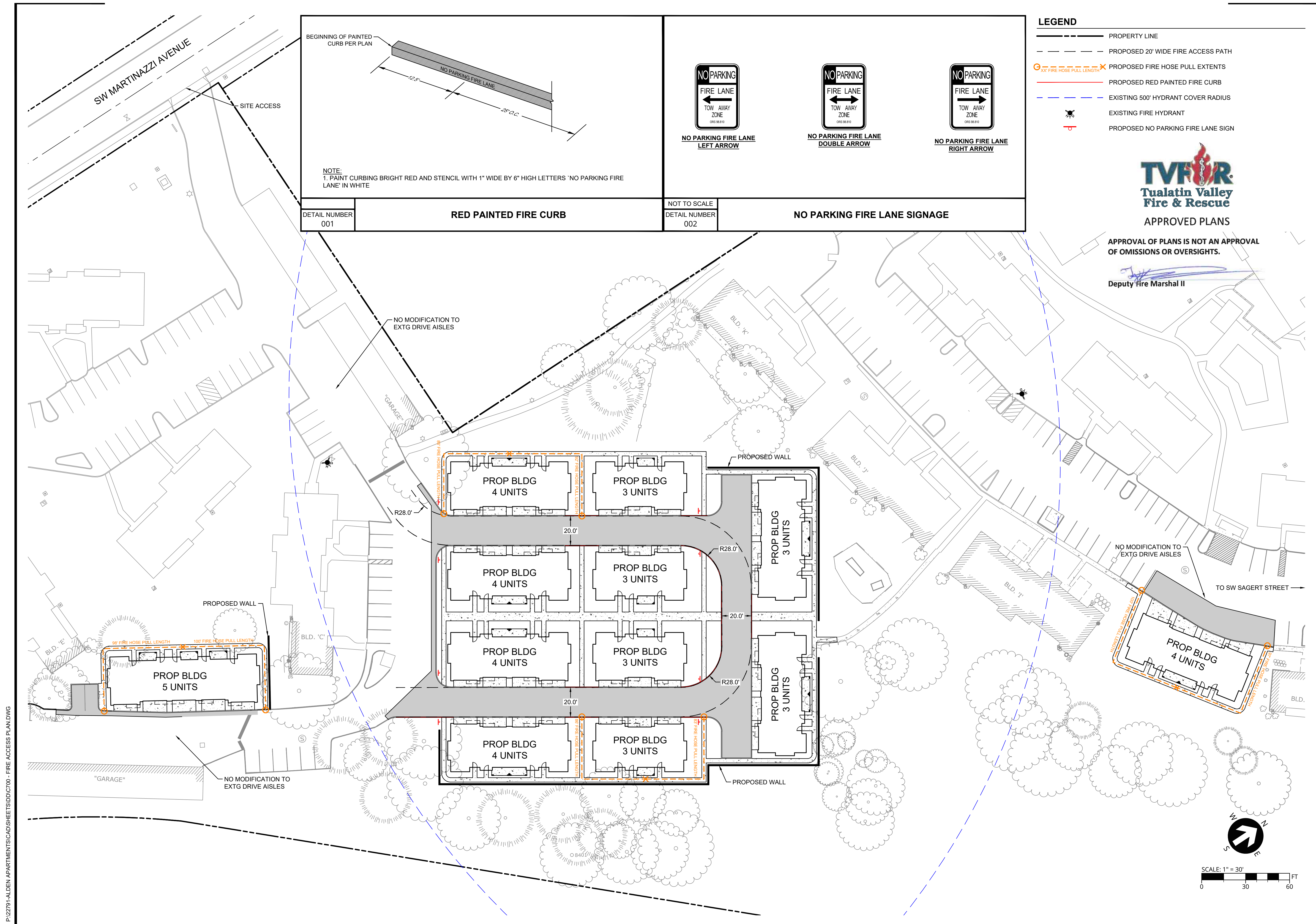

- LEGEND**
- — — — — PROPERTY LINE
 - - - - - PROPOSED 20' WIDE FIRE ACCESS PATH
 - XX--- PROPOSED FIRE HOSE PULL EXTENTS
 - — — — — PROPOSED RED PAINTED FIRE CURB
 - --- EXISTING 500' HYDRANT COVER RADIUS
 - ⊙ EXISTING FIRE HYDRANT
 - ⊙ PROPOSED NO PARKING FIRE LANE SIGN

NOTE:
1. PAINT CURBING BRIGHT RED AND STENCIL WITH 1" WIDE BY 6" HIGH LETTERS 'NO PARKING FIRE LANE' IN WHITE

DETAIL NUMBER 001 **RED PAINTED FIRE CURB**

NOT TO SCALE
DETAIL NUMBER 002 **NO PARKING FIRE LANE SIGNAGE**

NO PARKING
FIRE LANE
TOW AWAY ZONE
ORS 96.810

**NO PARKING FIRE LANE
LEFT ARROW**

NO PARKING
FIRE LANE
TOW AWAY ZONE
ORS 96.810

**NO PARKING FIRE LANE
DOUBLE ARROW**

NO PARKING
FIRE LANE
TOW AWAY ZONE
ORS 96.810

**NO PARKING FIRE LANE
RIGHT ARROW**



APPROVAL OF PLANS IS NOT AN APPROVAL OF OMISSIONS OR OVERSIGHTS.

[Signature]
Deputy Fire Marshal II

PUBLISH DATE

ISSUED FOR
DD
REVISIONS

FIRE ACCESS PLAN
ALDEN APARTMENTS

7800 SW SAGERT STREET
TUALATIN, OR 97062

3J CONSULTING

CIVIL ENGINEERING
WATER RESOURCES
COMMUNITY PLANNING

9600 SW NIMBUS AVE., SUITE 100, BEAVERTON, OR 97008

PROJECT INFORMATION

3J PROJECT # | 22791
TAX LOT(S) | 2S125BA00100
LAND USE # | 22-0004
DESIGNED BY | KMK
CHECKED BY | BMO

SHEET NUMBER
FS-1

P:\22791-ALDEN APARTMENTS\CAD\SHEETS\DDC700 - FIRE ACCESS PLAN.DWG