

**WASHINGTON COUNTY OREGON**  
 SE1/4 SE1/4 SECTION 15 T2S R1W W.M.  
 SCALE 1" = 100'

36	31	32	33	34	35	36	31
1	6	5	4	3	2	1	6
12	7	8	9	10	11	12	7
13	18	17	16	15	14	13	18
24	19	20	21	22	23	24	19
25	30	29	28	27	26	25	30
36	31	32	33	34	35	36	31
1	6	5	4	3	2	1	6

FOR ADDITIONAL MAPS VISIT OUR WEBSITE AT  
[www.co.washington.or.us](http://www.co.washington.or.us)

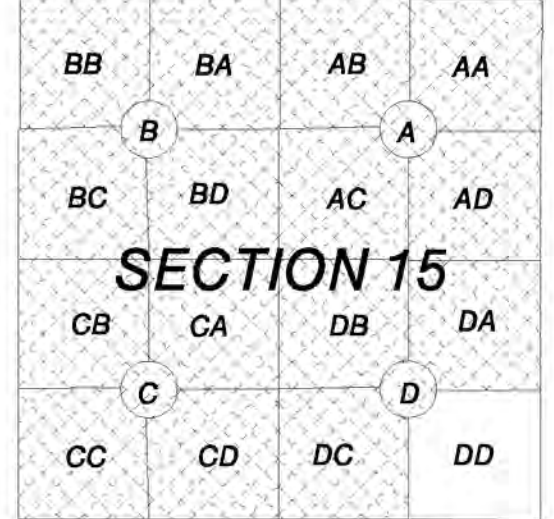

Cancelled Taxlots For: 2S115DD  
 3700,101,200,3400,7100,100,300,4200,400,500,601,4201,  
 4401,4402,3500,3600,3800,3900,4000,4100,14700,16901,  
 18001,18201,18501,9600,4300,18900,600,4400,

**ANNEXATION CERTIFIED BY**  
**WASHINGTON COUNTY**  
**CARTOGRAPHY**  
 3/11/2020

WASHINGTON COUNTY  
 OREGON  
 Assessment  
 CARTOGRAPHY  
 Taxation

PLOT DATE: June 22, 2006  
 FOR ASSESSMENT PURPOSES  
 ONLY - DO NOT RELY ON  
 FOR OTHER USE

Map areas delineated by either gray shading or a cross-hatched pattern are for reference only and may not indicate the most current property boundaries. Please consult the appropriate map for the most current information.