



SPECIAL WORK SESSION OF THE
TUALATIN CITY COUNCIL

THURSDAY, MARCH 17, 2022
6:30 P.M.

Phone: +1 669 900 6833
Meeting ID: 861 2129 3664
Password: 18880

Link: <https://us02web.zoom.us/j/86121293664?pwd=SS9XZUZyT3FnMk5rbDVKN2pWbnZ6UT09>

Call to Order

Welcome and Introductions

Discussion with Community Involvement Organization (CIO) Leadership

Adjournment

Meeting materials, including agendas, packets, public hearing and public comment guidelines, and Mayor and Councilor bios are available at www.tualatinoregon.gov/council.

Tualatin City Council meets are broadcast live, and recorded, by Tualatin Valley Community Television (TVCTV) Government Access Programming. For more information, contact TVCTV at 503.629.8534 or visit www.tvctv.org/tualatin.

In compliance with the Americans with Disabilities Act, this meeting location is accessible to persons with disabilities. To request accommodations, please contact the City Manager's Office at 503.691.3011 36 hours in advance of the meeting.



Chat

Sallie Olson to Everyone

Exactly how did Washington County cram this bridge down our throats?

Cathy Holland to Everyone

Megan - can you get us a copy of the Mayor's letter to the gun club?



Me to Everyone

I'll work on it.

Cathy Holland to Everyone

What is Clean Water Services doing? Is there a plan?

Ed Casey to Everyone

I looked at both plans mentioned. At Island Greens, they will take out 60 trees 24" or larger in diameter (up to 52" doug fir). At the Horizon housing plan, the tree "expert" commented that ALL the trees should be removed!

Tammy to Everyone

I am assuming Tualatin will no longer qualify as a tree city, correct? This huge number of trees being removed without plans for replacement is an abrupt departure from our proud tree heritage.

Ed Casey to Everyone

If Roy Rogers is our rep. on Washington County Commissioners, we need him to make a visit. I doubt he has driven through town in the am or pm traffic battle. I've seen a backup from I-5 at Wilsonville, past Tualatin High School and nearly to McDonalds! - Others have seen similar.

The problem is not with the City or it's employees or representatives. It is that we do NOT have a Housing Plan (one of the few cities in Oregon that doesn't). Read the Housing Plans for Wilsonville, Sherwood, Beaverton etc. They have a "vision" of what they want their cities to look like and to live in. We don't....

Ed Casey to Everyone

Bridget, A true housing plan is much different than a "comprehensive" or "development" plan. Look over some of them - you'd be amazed on how they look at development in their cities.

Ed Casey to Everyone

124th looks like a war zone!

Valerie Pratt to Everyone

To contact Washinton County Commissioners:
.washington.or.us/BOC/ click on comissioner tab on left

Alex Thurber to Everyone

I have to exit; thank you for hosting this event and for listening to the input from the CIO's.

Bridget Brooks, MSW (She/Her) to Everyone

nice to see you Alex!

Valerie Pratt to Everyone

co.washington.or.us/BOC/

council@tualatin.gov

G Lucini to Everyone

If the Basalt Creek Parkway Extension Project did not occur, there would be fewer trees negatively impacted, less high valued habitats negatively impacted, and less concrete put down in natural areas.

Bridget Brooks, MSW (She/Her) to Everyone

Agreed Grace!

Tammy to Everyone

Thank you Bridget.

Ed Casey to Everyone

GREAT MEETING - THANKS TO ALL

Christen Sacco to Everyone

Thank you everyone!



Special Work Session

City Council of Tualatin and Tualatin CIO Leaders

March 17, 2022



Agenda Overview

- Overview and update on CIO activities since Megan George's report on 9/13/21 to the Council – Cathy Holland
- Noise reduction efforts to date – Patricia Parsons
- Unless COVID returns, Riverpark Community Fair at Jurgens Park – Janine Wilson
- Concerns needing City Council support – Cathy Holland
- City Council Members Comments – City Council Members
- Next steps – City Council Members



CIOs History of Tackling Tough Problems

- Riverpark worked with DEQ enforcement & Grimm's Fuel to establish Good Neighbor Agreement with odor monitoring
- CCIO worked with City rewriting zoning for Blocks 28 & 29
- All CIOs supported establishment of Tualatin CERT & emergency training for neighborhoods
- East CIO assisted neighborhood members and Legacy in reaching an acceptable development plan



CIOs History of Tackling Tough Problems

(Continued)

- CCIO encouraged the odor reduction from burning animals by helping ensure crematorium in downtown Tualatin followed permit requirements after discovering the City had no enforcement
- Nearly all CIOs used grant funding to help with local projects such as dog waste control, park benches, Neighborhood Night Out, and community events
- All CIOs have commented on proposed building projects



Tualatin Community Involvement
Organizations (CIOs)

New Website Launched

[Home](#) & [Residential CIOs](#) [Commercial CIO](#) [More](#)

We care!
Which
CIO is
yours?





CIO Activities Since 9/13/21

- Coming out of COVID meeting restrictions, we hope!
- 2 CIOs held virtual annual meetings
- Multiple CIOs provided public comments at planning commission hearings
- 5 CIOs plan virtual or in person annual meetings before 6/30
- 5 CIOs have full or nearly full boards; 2 plan to fill at annual meeting



CIO Activities Since 9/13/21

(Continued)

- 7 CIOs are reviewing grant request opportunities
- CERT training and Zoom Tualatin Neighborhood Ready Presentations continue
- 3/15 City removed mask restrictions; meeting rooms are now available
- Ibach CIO leader recently met with Mayor & State Representative with ideas to reduce noise pollution



Riverpark Community Fair

May 14th from 1 to 3 pm- Jurgens Park

- Focus on families and children
- Using fiscal grant for shelter rental, packaged snacks/treats, supplies
- Inviting nonprofit groups and others including
 - Neighbors Nourishing Communities (giving away seeds; plants)
 - Friends of the Library
 - CERT Riverpark Command Center & Radio demos
 - Animal rescue display
- City of Tualatin Parks Department activity opportunities



Categories of Concerns Unprotected by City Ordinances

- Washington County Development
- Traffic
- Noise & Tree loss



Washington County

Pattern of Ignoring Public Input
(Multiple Legal Actions Pending)

State Land Use Commission issues enforcement order against Washington County for failure to comply with land use goals to protect natural resources (June 6, 2020).



Sign up now!
Free! Sign up to receive Cedar Mill News
in your inbox every month!

March 2022
Articles

Sunset BSU
moves community
to peaceful
demonstration
march

Postal service in
Cedar Mill

June 2020:
COVID-19 in
Washington
County

State Land Use Commission issues enforcement order against Washington County

June 6, 2020 | [Development](#)

CPO 4M Press Release

The Oregon Land Conservation and Development Commission (LCDC) has issued an enforcement order against Washington County for its lack of compliance with statewide land use planning goals designed to protect significant natural resources. LCDC also went a step further and imposed an injunction on the County, prohibiting it from processing applications for developments in designated “Wildlife Habitat” until it comes into compliance with state law by adopting new and enforceable regulations to protect the resources. Under LCDC’s order, the County has until May 1, 2021 to come into compliance.

Citizens will work with the County in crafting new ordinances, ensuring that the remaining 15% of these Wildlife Habitats are protected to safeguard their existence for future generations.



Washington County

Pattern of Ignoring Public Input

- Ignores (even lost records) public input from multiple meetings over many years regarding the environmental impact of building Basalt Creek Parkway
- Parkway bridge extension doesn't help traffic, unless and until, Clackamas County agrees to an extension over I-5, into the Stafford Hamlet, and with a connection to I-205
- Current road terminates at SW Grahams Ferry; trucks turn right and go to the Wilsonville on ramp to I-5
- Bridge extension to SW Boones Ferry shoves traffic on to an overburdened SW Boones Ferry



Washington County

Pattern of Ignoring Public Input

- County Parkway environmental report not consistent with previous Metro studies
- Noise analysis states sound buffers too expensive; this is not a reason to exclude them from the project
- Noise study only included existing housing; not proposed housing across from the bridge
- Bridge will amplify truck traffic noise across Tualatin neighborhoods



Questions for the City Council:

Can you help? Would the City Council consider recommending a delay until the Clackamas County Parkway connection is confirmed? Would you consider the need for noise buffers if the bridge is built?



Traffic

- Traffic studies during Covid understated normal peak traffic
- Current Transportation Plan understated the current overflow traffic from I-5 onto SW Boones Ferry and SW 65th
- Using those outdated or understated traffic studies for new developments will overwhelm existing neighborhoods
- Transit improvements continue to be for limited or no services for essential workers; forcing them to park and drive
- Trying to enter traffic on SW Boones Ferry from SW Iowa during peak periods is dangerous



Questions for the City Council:

Can you help? Would the City Council consider updating traffic studies for after Covid to more accurately determine the impact of increased development? Can we get committed transit solutions for SW Boones Ferry and SW 65th?



Noise & Trees

- With the development of SW 124th, neighborhood noise levels have increased
- According to reports in the publication *Planet Earth* (among others), trees are able to reduce or attenuate sound by intercepting sound waves and changing their behavior
- Different plant parts reduce noise by absorbing, deflecting, or refracting sound waves depending on their physical characteristic
- ODOT requires a barrier of trees and tall shrubs along highways to protect businesses and residents from highway noise
- Current City development standards require an arborist report but do not require trees be saved or replaced if they interfere with the building site

Examples of Tree Loss Which Will Further Hurt Sound Absorption

- Autumn Sunrise (off Norwood) tree loss on site tree loss 97% (3064 trees)

Total # of Existing Trees Inventoried = 3388	
Total # of Existing Onsite Trees = 3141	Total # of Existing Line Trees = 18
Total # of Existing Onsite Trees to be Preserved = 77	Total # of Existing Line Trees to be Preserved = 0
Total # of Existing Onsite Trees to be Removed = 3064	Total # of Existing Line Trees to be Removed = 18
Total # of Existing Offsite Trees = 229	
Total # of Existing Offsite Trees to be Preserved = 124	
Total # of Existing Offsite Trees to be Removed = 105	
*Health Rating:	

- Tualatin Logistics Park (formerly Island Green) on site tree loss 93% (415 trees)

Conclusion

The proposed development requires the removal of 415 trees over 8-inches in diameter. Trees on the property lines and off the property but with encroaching roots can be adequately protected from the proposed grade changes with tree protection fencing.

Landscaping Plans Need More Tall Evergreen Trees (Helps reduce noise)

Tualatin's development code requires landscaping plans. Those plans, however, do not emphasize fir tree replacement and use small deciduous trees/dwarf spruces/shrubs. The beds are narrow to maximize useable space. Could we change to create more sound buffers? Current example: Tualatin Logistics Park (formerly Island Green).

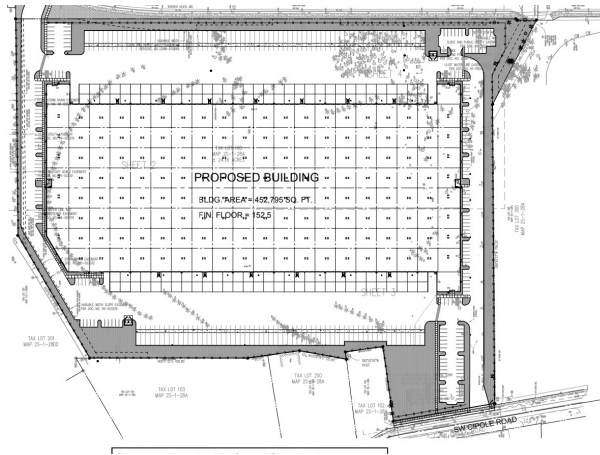

Basalt Creek Development

Besides the opportunity to change landscaping requirements for new development, there is a significant area along 124th still being reclaimed. Could this become a noise abatement area with a cooperative agreement with the owners?

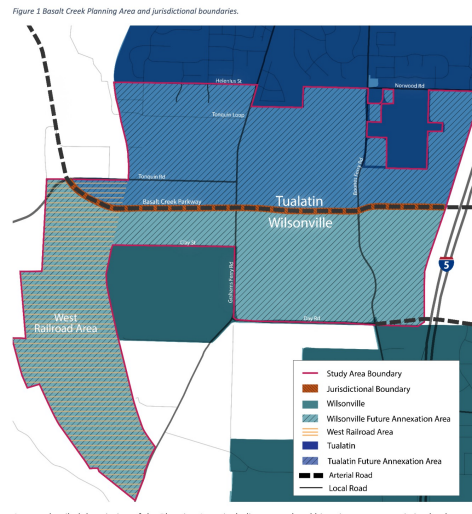



Questions for the City Council:

Can you help? Would the City Council consider updating ordinances for increased evergreen tree planting as part of the development code? Consider updating public right-of-way codes to add more tree barriers? Work with Washington County to plant trees in the reclaimed area not expected to developed for some time? Other options?



City Council Comments

Thank You!